

**APPLICATION
FOR SEWAGE SYSTEM
CERTIFICATE OF COMPLIANCE**
With The Becker County Zoning Ordinance



0000

Tax Parcel Number
050000000

Fire Number of Project Location

A. GENERAL INFORMATION

1. Applicant's Name (Last, First, M.I.) <u>Welbye, Alan</u>		2. Authorized Agent (If applicable)	
3. Mailing Address (Street, RFD, Box Number, City, State, Zip Code) <u>Route 3 Box 253 Detroit Lakes mn</u>			
4. Day Phone	5. Evening Phone	6. Section <u>5</u>	7. Township <u>Detroit</u>

B. PROPERTY DESCRIPTION

1. Lot(s), Block, Subdivision Name
250 FT N + S BY 600 FT E + W IN SW COR NW 1/4 NW 1/4

7. Note: If the property is a metes and bounds description, check here [] and attach a copy of the exact legal description.

SEWAGE SYSTEM DATA

Anticipated Use

a. Single Family

b. Multiple Family

c. Commercial

d. Agricultural

e. Other (specify)

Type of System

a. Septic Tank Only

b. Drainfield Only

c. Septic Tank & Drainfield

d. Holding Tank

e. Alternative System (specify)

Type of Drainfield

a. Standard System

b. Mound (pressure distribution)

c. Mound (gravity distribution)

Well Data

a. Depth: 225'

b. Diameter: 4"

Type of Well

a. Drilled

b. Sand Point

1 Inch Equals 50
DESIGN

30 yards Rock
Jutz Installer

Show Distance Between Sewage System And Buildings,
Property Lines, Lake, Roads And All Wells Within 125 Feet.

	Tank	Drainfield		Tank	Drainfield
Distances to Well:	- <u>70</u>	- <u>52</u>	Distance to Pressure Line:	- <u>35'</u>	- <u>35'</u>
Distance to Building:	- <u>+ 10</u>	- <u>+ 20</u>	Tank Capacity (gal.) & Area of Drainfield (ft. 2):	- <u>1000</u>	- <u>1000</u>
Distance to Property Line:	- <u>+ 75</u>	- <u>+ 25</u>	Distance to Ordinary High Water Level:	- <u>N/A</u>	- <u>N/A</u>
Distance to Suction Line:	- <u>N/A</u>	- <u>N/A</u>	Drainfield Separation from Highest Known Ground Water Level, Impervious Lens or Soil Mottling:	- <u>N/A</u>	- <u>+ 3 feet</u>

I hereby certify with my signature that all data on my application forms, plans and specifications are true and correct: _____

Signature of Applicant Date

TO BE COMPLETED BY ZONING OFFICE

CERTIFICATE IS HEREBY DENIED: (See Back For Reasons)

CERTIFICATE IS HEREBY GRANTED; Based upon the application, addendum form, plans, specifications and all other supporting data. With proper maintenance this system can be expected to function satisfactorily, however this is not a guarantee.

BECKER COUNTY ZONING OFFICE

Joseph Auerby
Signature

Jonas Olson
Title

4-15-93
Date

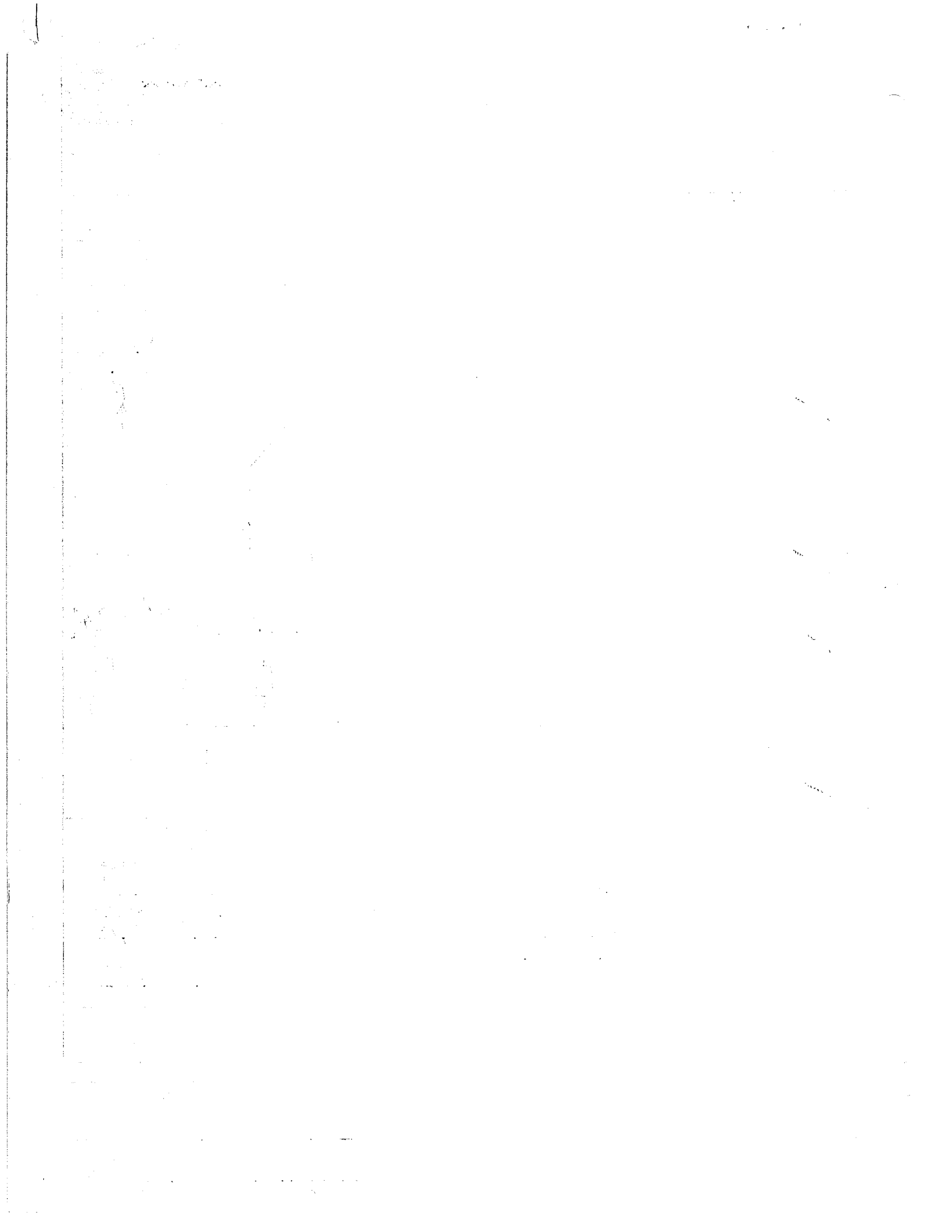

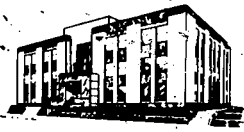

BECKER COUNTY

829 LAKE AVENUE, P.O. BOX 787
DETROIT LAKES, MINNESOTA 56502-0787
(218) 846-7314

ZONING APPLICATION SUMMARY FORM FORM A

Fire No.
Application No. 0383
Tax Parcel No. 08008000

A. GENERAL INFORMATION

1. Applicant's Name (Last, First, M.I.) Weibye, Alan		2. Authorized Agent (if applicable)	
3. Mailing Address (Street, RFD, Box Number, City, State, Zip Code) Route 3 Box 253 DL			
4. Day Phone	5. Evening Phone	6. Section 5	Township Detroit

B. PROPERTY DESCRIPTION

1. Lot(s), Block, Subdivision Name 250FT N+S Bx 600FT E+W in SWCOR NW1/4 NW1/4
2. Note: If the property is a metes and bounds description, check here <input type="checkbox"/> and attach a copy of the exact legal description.

C. APPLICABLE ZONING DISTRICTS

(check all that apply)

- Residential
- Business
- Commercial
- Industrial
- Agricultural
- Shoreland(*)
- Other

*Fill in Section E. also.

D. TYPE OF ZONING REQUEST

Project Type	Necessary Supplemental Form
1. <input type="checkbox"/> Building Permit	Form B and H
2. <input checked="" type="checkbox"/> Sewage System Permit	Form C and H
3. <input type="checkbox"/> Setback Certificate	
4. <input type="checkbox"/> Land Alteration Permit	Form E and H
5. <input type="checkbox"/> Conditional Use Permit	Form F
6. <input type="checkbox"/> Variance	Form G
7. <input type="checkbox"/> Zoning District Change	Form F
8. <input type="checkbox"/> Subdivision Approval	Form F
9. <input type="checkbox"/> Ordinance Amendment	Form F
10. <input type="checkbox"/> Other (specify below)	

E. SHORELAND MANAGEMENT DATA

- Lake / Stream Name N/A
- Lake / Stream I.D. Number _____
- Classification: NE; RD; GD;
 Other (specify below)

- IMPORTANT NOTICE -
Most projects require the submission of one or more additional forms as shown in SECTION D. and sometimes plans, specifications and a written project description before your application is considered to be complete. Form A primarily provides summary information for record keeping.

I hereby certify with my signature that all data contained herein as well as all supporting data are true and correct to the best of my knowledge:

Signature _____ Date _____

F. ADMINISTRATIVE DATA SUMMARY (For Office Use Only)

1. <input type="checkbox"/> Proper addendum to application has been submitted.	10. Administrative Summary for Applications for Subdivision Approval, Variances, Conditional Use Permits, Ordinance Amendments and Zoning District Changes:
2. <input type="checkbox"/> Detailed plans have been submitted which were prepared by: _____ Dated: _____	a. Referred to Township on: _____
3. <input type="checkbox"/> Written project description has been submitted which was prepared by: _____ Dated: _____	b. Referred to Planning Commission on: _____
4. <input checked="" type="checkbox"/> Approved <input type="checkbox"/> with, <input checked="" type="checkbox"/> without modification on: <u>4-12-93</u>	c. Referred to Board of Adjustment on: _____
5. <input type="checkbox"/> Denied on: _____	d. Referred to County/City Engineer on: _____
6. Itemization of Fees:	e. Referred to County/City Attorney on: _____
General Application <u>60.00</u>	f. Referred to Soil and Water Cons. Dist. on: _____
State Surcharge <u>50</u>	g. Referred to Watershed District on: _____
_____	h. Date of Hearing Notice: _____
_____	i. Date of Public Hearing: _____
_____	j. Is ten (10) day notice to the DNR necessary? <input type="checkbox"/> yes, <input type="checkbox"/> no
7. Total Fees = <u>60.50</u>	If yes, enter date sent to DNR here: _____
8. Fee paid on (date): <u>4-12-93</u>	k. Is ten (10) day final notice to the DNR necessary? <input type="checkbox"/> yes, <input type="checkbox"/> no
9. Administrative Summary for Building Permits, Sewage System Permits, and Shoreland Alteration Permits.	If yes, enter date sent to DNR here: _____
a. Dates of inspection(s): _____	l. Final Action: <input type="checkbox"/> APPROVED <input type="checkbox"/> with, <input type="checkbox"/> without modification
b. Certificate of Occupancy (Zoning Compliance) issued on: _____	<input type="checkbox"/> DENIED
	By: <input type="checkbox"/> County Board; <input type="checkbox"/> Board of Adjustment
	Date of Action: _____

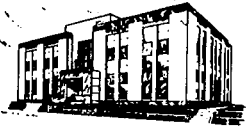

BECKER COUNTY

829 LAKE AVENUE, P.O. BOX 787
DETROIT LAKES, MINNESOTA 56502-0787
(218) 846-7314

SUPPLEMENTAL DATA FOR SEWAGE SYSTEM PERMIT FORM C

Fire No.
Application No. <u>6383</u>
Tax Parcel No. <u>00.000000</u>

A. GENERAL INFORMATION

1. Applicant's Name (Last, First, M.I.) <u>WEIDYE ALAN L</u>		
2. Sewer Installer <u>Ed Jutz</u>	3. Soil Tester/Earthwork Contractor <u>Same</u>	4. MPCA Certification No. <u>1590</u>

B. SEWAGE SYSTEM DATA

C. SITE DATA

<p>1. Work Category</p> <p>a. <input type="checkbox"/> New System b. <input checked="" type="checkbox"/> Repair</p> <p>3. Anticipated Use</p> <p>a. <input checked="" type="checkbox"/> Single Family b. <input type="checkbox"/> Multiple Family c. <input type="checkbox"/> Commercial d. <input type="checkbox"/> Agricultural e. <input type="checkbox"/> Other (specify)</p>	<p>2. Type of System</p> <p>a. <input type="checkbox"/> Septic Tank Only b. <input type="checkbox"/> Drainfield Only c. <input checked="" type="checkbox"/> Septic Tank & Drainfield d. <input type="checkbox"/> Alternative System (specify)</p> <p>4. Type of Drainfield</p> <p>a. <input checked="" type="checkbox"/> Standard System b. <input type="checkbox"/> Mound (pressure distribution) c. <input type="checkbox"/> Mound (gravity distribution)</p>	<p>1. Soils</p> <p>a. Soil Type: _____ b. Percolation Rate (minutes per inch): _____ c. Depth to Water Table: <u>100'</u></p> <p><u>6" ROCK</u> <u>4" PIPE</u></p>	<p>2. Supporting Data/Attachments</p> <p><input checked="" type="checkbox"/> Sketch Plan** <input type="checkbox"/> Percolation Data Sheets <input type="checkbox"/> Soil Borings <input type="checkbox"/> Tank/Drainfield Design Calculations</p>																											
<p>5. System Design Data</p> <table border="1"> <thead> <tr><th></th><th>Tank</th><th>Drainfield</th></tr> </thead> <tbody> <tr><td>a. Distance to Well:</td><td><u>68'</u></td><td><u>60'</u></td></tr> <tr><td>b. Distance to Building:</td><td><u>40'</u></td><td><u>50'</u></td></tr> <tr><td>c. Distance to Property Line:</td><td><u>100'</u></td><td><u>10'</u></td></tr> <tr><td>d. Distance to Suction Line:</td><td><u>N/A</u></td><td><u>N/A</u></td></tr> <tr><td>e. Distance to Pressure Line:</td><td><u>35'</u></td><td><u>35'</u></td></tr> <tr><td>f. Tank Capacity (gal.) and Area of Drainfield (ft. 2):</td><td><u>1,600 GAL. 500 LIFT</u></td><td><u>1,000 FT² 35' x 30'</u></td></tr> <tr><td>g. Distance to Lake or Stream (from Ordinary High Water Level):</td><td><u>1/2 mi</u></td><td><u>N/A</u></td></tr> <tr><td>h. Drainfield Separation from Highest Known Ground Water Level, Impervious Lens or Soil Mottling:</td><td></td><td><u>4'</u> <u>4'</u></td></tr> </tbody> </table>			Tank	Drainfield	a. Distance to Well:	<u>68'</u>	<u>60'</u>	b. Distance to Building:	<u>40'</u>	<u>50'</u>	c. Distance to Property Line:	<u>100'</u>	<u>10'</u>	d. Distance to Suction Line:	<u>N/A</u>	<u>N/A</u>	e. Distance to Pressure Line:	<u>35'</u>	<u>35'</u>	f. Tank Capacity (gal.) and Area of Drainfield (ft. 2):	<u>1,600 GAL. 500 LIFT</u>	<u>1,000 FT² 35' x 30'</u>	g. Distance to Lake or Stream (from Ordinary High Water Level):	<u>1/2 mi</u>	<u>N/A</u>	h. Drainfield Separation from Highest Known Ground Water Level, Impervious Lens or Soil Mottling:		<u>4'</u> <u>4'</u>	<p>b. Well Data:</p> <p>a. Depth: <u>= 225'</u> d. <input checked="" type="checkbox"/> Drilled g. <input type="checkbox"/> Public b. Diameter: <u>= 4"</u> e. <input type="checkbox"/> Sand Point h. <input checked="" type="checkbox"/> Private Well c. Depth of Casing: <u>= 225'</u> f. <input type="checkbox"/> Augered</p> <p>Water Uses:</p> <p><input checked="" type="checkbox"/> Water Softener <u>NO</u> Dishwasher <input checked="" type="checkbox"/> Washing Machine <u>NO</u> Garbage Disposal</p> <p><u>4</u> No. Bedrooms <u>2 1/2</u> No. Bathrooms</p>	
	Tank	Drainfield																												
a. Distance to Well:	<u>68'</u>	<u>60'</u>																												
b. Distance to Building:	<u>40'</u>	<u>50'</u>																												
c. Distance to Property Line:	<u>100'</u>	<u>10'</u>																												
d. Distance to Suction Line:	<u>N/A</u>	<u>N/A</u>																												
e. Distance to Pressure Line:	<u>35'</u>	<u>35'</u>																												
f. Tank Capacity (gal.) and Area of Drainfield (ft. 2):	<u>1,600 GAL. 500 LIFT</u>	<u>1,000 FT² 35' x 30'</u>																												
g. Distance to Lake or Stream (from Ordinary High Water Level):	<u>1/2 mi</u>	<u>N/A</u>																												
h. Drainfield Separation from Highest Known Ground Water Level, Impervious Lens or Soil Mottling:		<u>4'</u> <u>4'</u>																												

I hereby certify with my signature that all data on my application forms, plans and specifications are true and correct to the best of my knowledge: Alan L. Weidye 04/12/93
Signature of Applicant Date

SEWAGE SYSTEM PERMIT

APPLICATION IS HEREBY DENIED
 PERMISSION IS HEREBY GRANTED TO Alan Weidye

All in accordance with the application, addendum form, plans, specifications and all other supporting data, unless specified hereinafter in the GENERAL and/or SPECIAL PROVISIONS.

BY ORDER OF: Alan Weidye 783 A 4-12-93
Signature of Permitting Authority Title Date

NOTE: THIS PERMIT TERMINATES ON: _____ except as provided for by local ordinance and/or Minnesota Law.

- SEE REVERSE FOR GENERAL AND SPECIAL PROVISIONS -

Application Fee \$ 60.00 State Surcharge 50 Total \$ 60.50

PAGE 2
FORM C -SEWAGE SYSTEM PERMIT

GENERAL PROVISIONS

1. Permittee shall not cover the system authorized herein until such system has been inspected and determined to be compliant by the permitting authority. This provision can be waived only at the discretion of the permitting authority.
2. Where clay soils are predominant, no drainfield excavation can proceed if more than one (1) inch of total rainfall has been received at the nearest official rain gauge within one (1) week prior to construction. This provision can only be waived at the discretion of the permitting authority.
3. No changes in plans or specifications can be made to the work authorized herein unless such change is first approved in writing by the permitting authority.
4. Permittee shall grant access to the site at all reasonable times so that the permitting authority or his/her agents may conduct inspections to ascertain compliance with the terms and conditions of this permit.
5. The construction site shall be kept reasonably free of debris at all times so as to not create a public nuisance.
6. Permittee shall install permanent and temporary erosion control measures in order to prevent erosion of disturbed soils from the project site onto adjacent parcels of land, public waters, public roads, ditches, sewer facilities and the like. Permittee shall cease all related authorized construction activities until such time as any such problem is corrected as agreed to by the permitting authority.
7. No certificate of occupancy or zoning compliance may be issued until all the provisions and conditions of this permit are complied with in full.
8. A copy of this permit or an official notice or placard thereof must be posted in a conspicuous place protected from the effects of weather no more than 12 feet above grade on the premises which the work is to be done and shall be maintained there until completion of said work.
9. The granting of this permit does not exempt the permittee from having to secure other permits from other state, federal or local units of government which may have jurisdiction over portions of the authorized project.
10. This permit does not allow the destruction or removal of any trees or vegetation which exists more than ten (10) feet beyond the foundation of the authorized structure or more than five (5) feet beyond the edge of a driveway or parking lot unless authorized in a Special Provision below.

_____ Date

_____ Signature of Applicant

SPECIAL PROVISIONS

1. 1,000 GAL SEPTIC TANK WITH 500 GAL INTERNAL LIFT PUMP
2. LIFT TO HAVE AUTOMATIC LIQUID LEVEL CONTROL AND ALARM
3. EXISTING TANK TO BE REMOVED & DISPOSED OFF
4. DRAIN FIELD TO BE 30" UNDER NEW ESTABLISHED GRADE OF LAWN
5. _____
6. _____

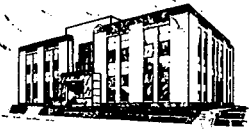

BECKER COUNTY

829 LAKE AVENUE, P.O. BOX 787
DETROIT LAKES, MINNESOTA 56502-0787
(218) 846-7314

Fire No.
Application No. 6383
Tax Parcel No. 8000000

SKETCH PLAN FORM H

Please be as complete as possible. Include all of the items listed below where applicable.

GENERAL CHECKLIST

- scale
- north arrow
- lot dimensions
- structure location
- side lot setback
- road setback
- septic tank location
- drainfield location
- location of all wells within 100' of drainfield
- fill & grading limits
- vegetation alteration limits

WATER RESOURCE CHECKLIST

- location of ordinary high water level (OHWL)
- location of present water line
- setback from OHWL
- location of highest known water level
- existing local drainage
- location of wetland areas

Scale of Diagram: 1 inch = _____ feet

Drawing By: ALAN WEIBYE

Date of Drawing: 09/10/93

Remarks: _____

Signature _____

West

ABANDONED WELL 1988

South

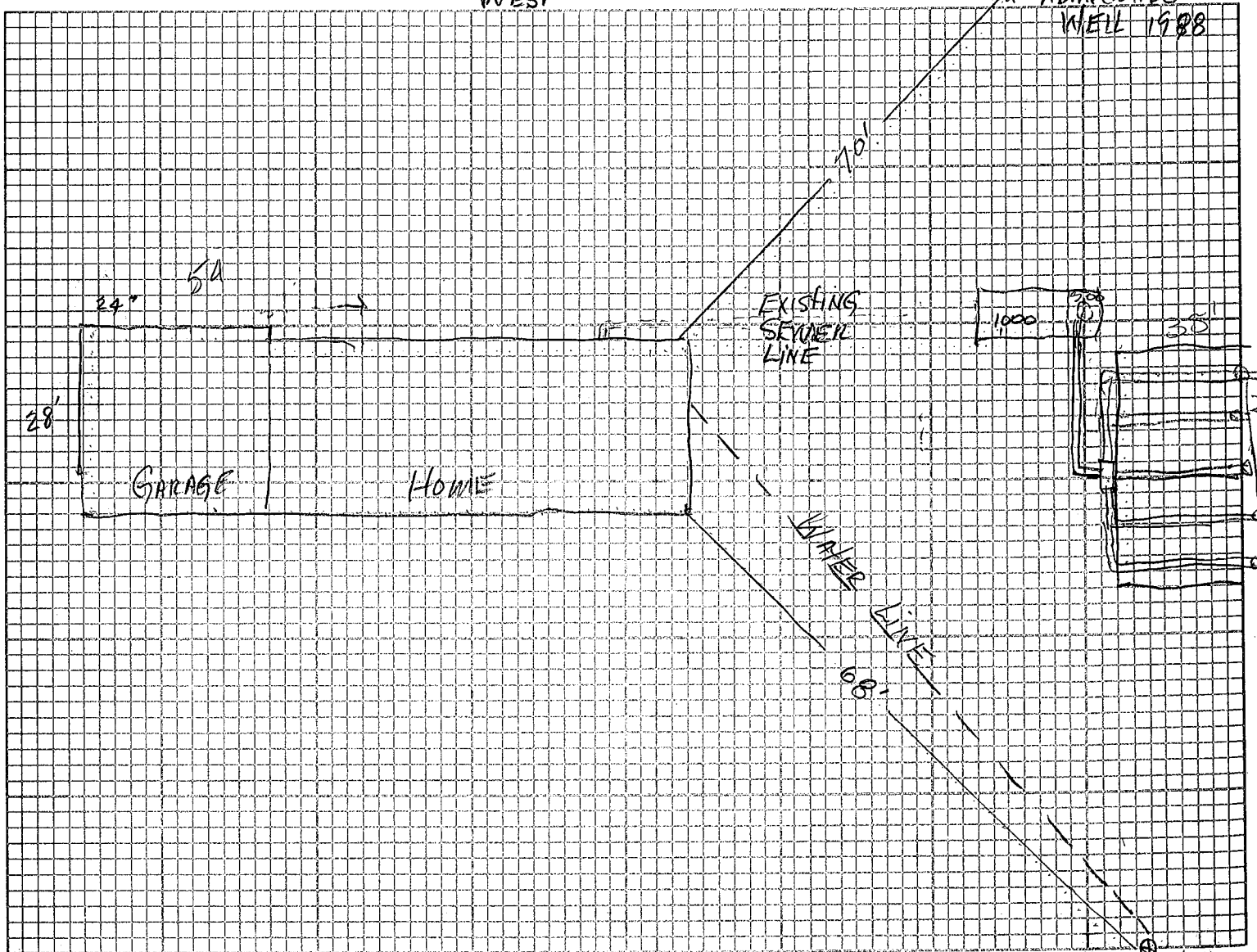

East

WELL